

DO NOT  
SCALE FROM  
THIS PRINT

NOTES:

1. THIS IS AN INDUSTRY STANDARD PRODUCT. MAKE NO CHANGES WITHOUT CONTACTING THE INDUSTRY STANDARD DEPARTMENT.
2. REPRESENTS A CRITICAL DIMENSION.
3. MAXIMUM CUT FLASH: .020[0.51].
4. MINIMUM CONTACT RETENTION: .5 LB.
5. MAXIMUM BURR: .005[0.13]
6. ENDWALL AFTER CUTTING: .031[.79] +/- .004[0.10], VOIDS MAY BE PRESENT. CONTACTS MUST NOT BE VISIBLE THROUGH THE ENDWALL
7. MAXIMUM HEIGHT VARIATION: .005[0.13].
8. PARTS TO BE PACKAGED IN UNIFORM LAYER.
9. ORDERS WILL BE PACKAGED ACCORDING TO THE SAMTEC PACKAGING EFFICIENCY STANDARDS (SPES) FOUND ON [WWW.SAMTEC.COM](http://WWW.SAMTEC.COM).

ANY REV TO THIS PRINT MUST HAVE AN UPDATED MKT PRINT

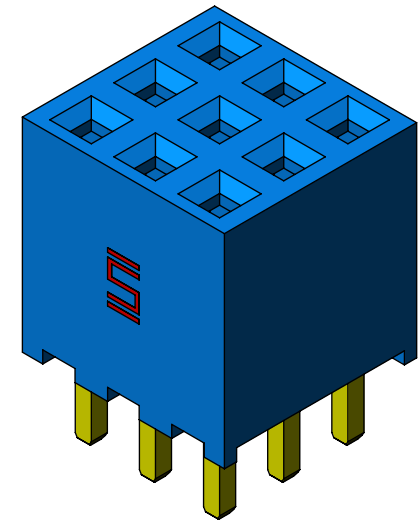
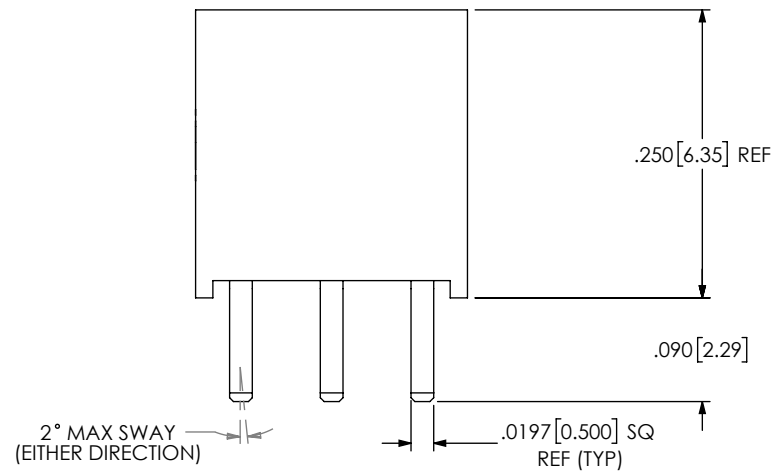
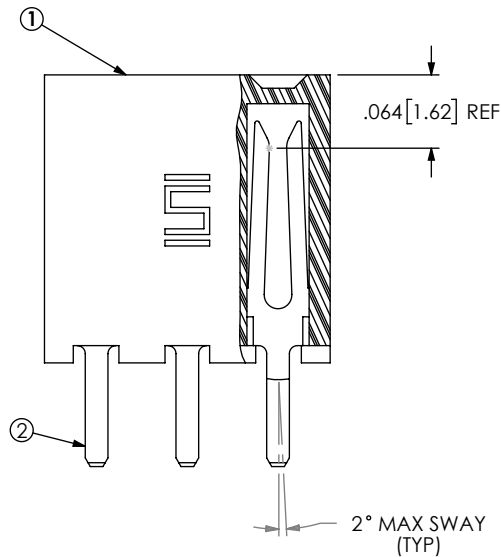
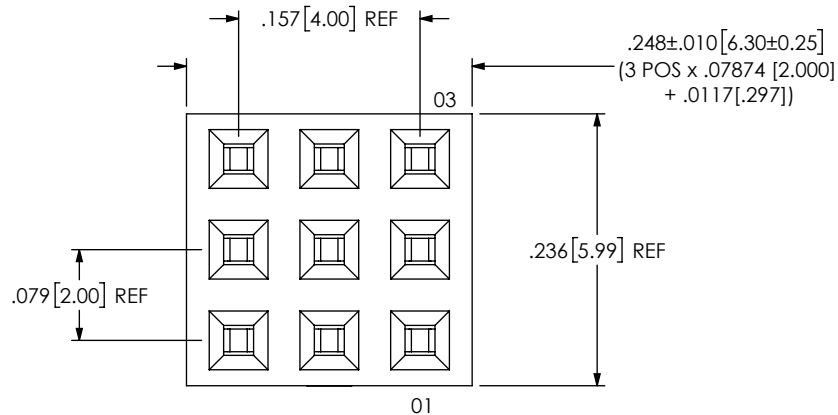

UNLESS OTHERWISE SPECIFIED,  
DIMENSIONS ARE IN INCHES.  
TOLERANCES ARE:  
DECIMALS ANGLES  
.XX: ±.01[0.3] 2°  
.XXX: ±.005[0.13]  
.XXXX: ±.0020[0.051]

**PROPRIETARY NOTE**  
THIS DOCUMENT CONTAINS CONFIDENTIAL AND  
PROPRIETARY INFORMATION AND ALL DESIGN,  
MANUFACTURING, REPRODUCTION, USE, PATENT RIGHTS  
AND SALES RIGHTS ARE EXPRESSLY RESERVED BY SAMTEC,  
INC. THIS DOCUMENT SHALL NOT BE DISCLOSED, IN WHOLE  
OR PART, TO ANY UNAUTHORIZED PERSON OR ENTITY NOR  
REPRODUCED, TRANSFERRED OR INCORPORATED IN ANY  
OTHER PROJECT IN ANY MANNER WITHOUT THE EXPRESS  
WRITTEN CONSENT OF SAMTEC, INC.

**samtec**

520 PARK EAST BLVD, NEW ALBANY, IN 47150  
PHONE: 812-944-6733 FAX: 812-948-5047  
e-Mail: [info@SAMTEC.com](mailto:info@SAMTEC.com) code: 55322

DO NOT SCALE DRAWING SHEET SCALE: 6:1  
PLATING:  
CONTACT AREA: .000020 GOLD OVER .000050 NICKEL  
REMAINDER: .000003 GOLD OVER .000050 NICKEL

DESCRIPTION: UxV/35 9-PIN 2mm SOCKET

DWG. NO. ASP-241063-01

BY: CHRISTIAN S. 12/13/2024 SHEET 1 OF 1