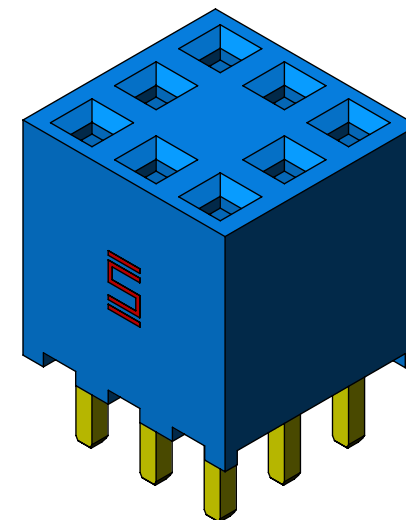
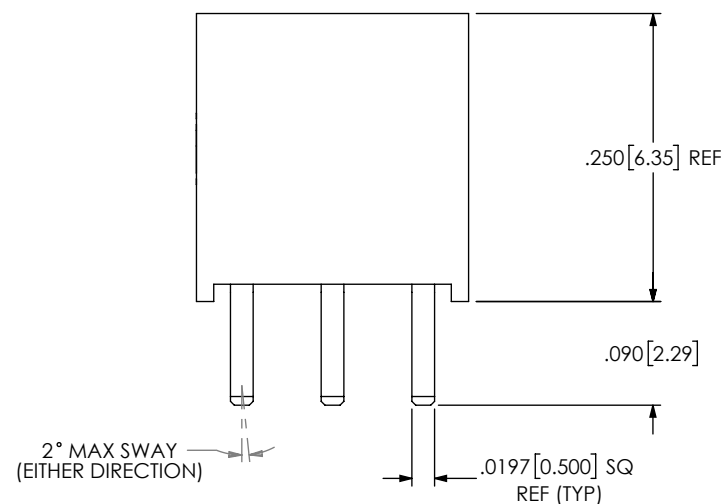
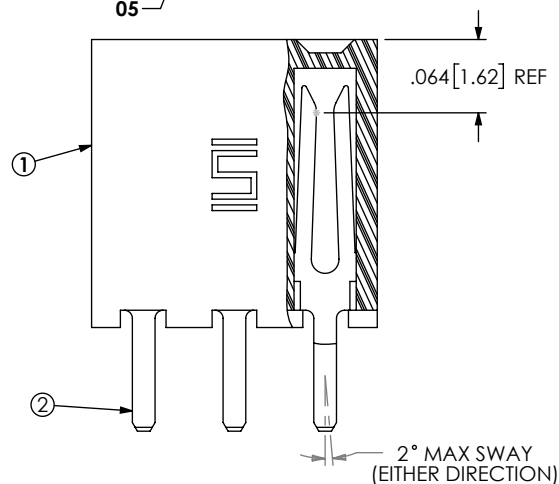
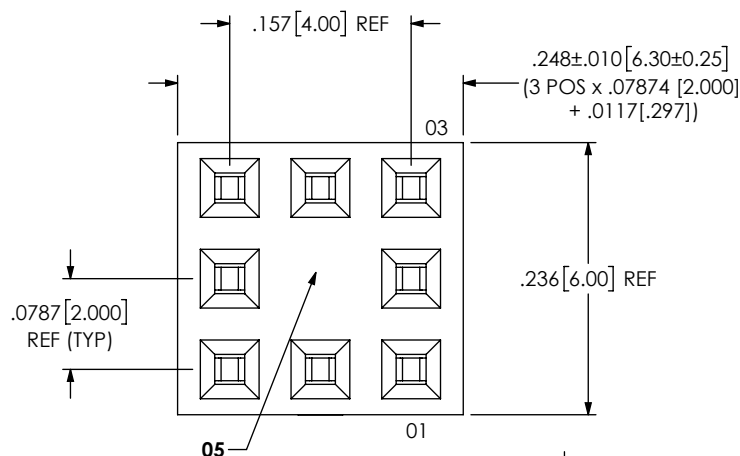

DO NOT
SCALE FROM
THIS PRINT

NOTES:

1. THIS IS AN INDUSTRY STANDARD PRODUCT. MAKE NO CHANGES WITHOUT CONTACTING THE INDUSTRY STANDARD DEPARTMENT.
2. REPRESENTS A CRITICAL DIMENSION.
3. MAXIMUM CUT FLASH: .020[0.51].
4. MINIMUM CONTACT RETENTION: .5 LB.
5. MAXIMUM BURR: .005[0.13]
6. ENDWALL AFTER CUTTING: .031[.79] +/-.004[0.10], VOIDS MAY BE PRESENT. CONTACTS MUST NOT BE VISIBLE THROUGH THE ENDWALL
7. MAXIMUM HEIGHT VARIATION: .005[0.13].
8. PARTS TO BE PACKAGED IN UNIFORM LAYER.
9. ORDERS WILL BE PACKAGED ACCORDING TO THE SAMTEC PACKAGING EFFICIENCY STANDARDS (SPES) FOUND ON WWW.SAMTEC.COM.

ANY REV MADE TO THIS PRINT MUST HAVE AN UPDATED MKT PRINT

UNLESS OTHERWISE SPECIFIED,
DIMENSIONS ARE IN INCHES.

TOLERANCES ARE:

DECIMALS

ANGLES

.XX: ±.01 [0.3]

2°

.XXX: ±.005 [0.13]

.XXXX: ±.0020 [0.051]

* PROPRIETARY NOTE *

THIS DOCUMENT CONTAINS CONFIDENTIAL AND PROPRIETARY INFORMATION AND ALL DESIGN, MANUFACTURING, REPRODUCTION, USE, PATENT RIGHTS AND SALES RIGHTS ARE EXPRESSLY RESERVED BY SAMTEC, INC. THIS DOCUMENT SHALL NOT BE DISCLOSED, IN WHOLE OR PART, TO ANY UNAUTHORIZED PERSON OR ENTITY NOR REPRODUCED, TRANSFERRED OR INCORPORATED IN ANY OTHER PROJECT IN ANY MANNER WITHOUT THE EXPRESS WRITTEN CONSENT OF SAMTEC, INC.

520 PARK EAST BLVD, NEW ALBANY, IN 47150
PHONE: 812-944-6733 FAX: 812-948-5047
e-Mail: info@SAMTEC.com code: 55322

PLATING:

CONTACT AREA: .000020 GOLD OVER .000050 NICKEL
REMAINDER: .000003 GOLD OVER .000050 NICKEL

DO NOT SCALE DRAWING

SHEET SCALE: 6:1

DESCRIPTION:

UxV/35 9-PIN 2mm SOCKET

DWG. NO.

ASP-241063-02

BY:DOSSEY D

12/16/2024

SHEET 1 OF 1